

# TATES

020 7602 6020



## Fitzgeorge Avenue, London W14 0SW

**£840,000**

- Beautifully presented flat
- Modern fitted kitchen
- Two very modern and stylish bathrooms
- Lift
- Energy Efficiency Rating Band D
- Reception room with generous ceiling height
- Two spacious double bedrooms
- First floor
- Close to Piccadilly and District line

# FITZGEORGE AVENUE, W14

Approximate gross internal area  
925 sq ft / 85.93 sq m

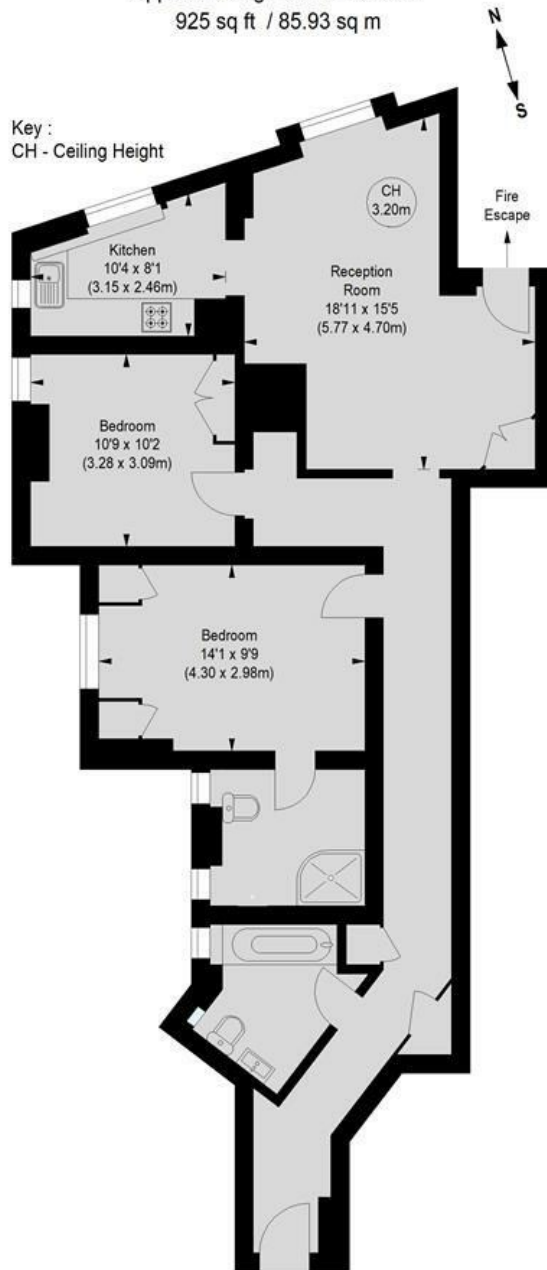

FIRST FLOOR

Not to scale, for guidance only and must not be relied upon as a statement of fact.  
All measurements and areas are approximate only

Whilst these particulars are produced in good faith and are believed to be correct, no guarantee is given, nor any responsibility accepted, by Tates nor by any of its representatives, for their accuracy. The particulars do not constitute part of any offer or contract, and it is recommended that such things as measurements, condition, structure, services, appliances, fixtures and fittings and facilities are all independently assessed by the prospective purchaser or renter of the subject property prior to committing to any contract.

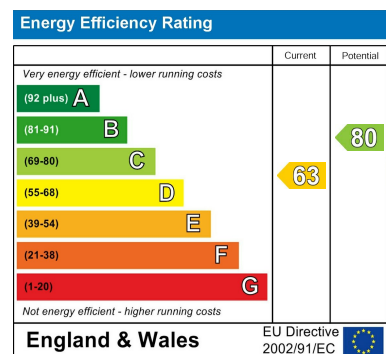

135 Hammersmith Road, West Kensington, London W14 0QL

mail@tatesestates.co.uk

tatesestates.co.uk

Tates (Agents) Ltd. Registered in England and Wales No. 02356337

Registered Office: Imperial House, 8 Keane Street, London WC2B 4AS

